

Manor Venture



Manor Venture is a multi-purpose offshore crew transfer vessel designed to transport personnel and equipment to and from offshore wind farms.

The state-of-the-art vessel was designed with a view to maximising the accommodation, deck space and load carrying capacity, whilst at the same time minimising overall weight and maintaining speeds of up to 22 knots.

At 26 metres LOA with three decks providing accommodation for 12 personnel, deck space of 135 m², fuel capacity of over 30 tonnes and an offshore endurance of 7 days, the Venture is a true multi-purpose vessel.

Key benefits

- Large fuel capacity of 35 tonnes for less frequent re-fuelling
- Rapid re-fuelling system for temporary power generators
- Seating for 12 passengers for high-speed transfer
- Accommodation for 4 crew and 8 Project personnel
- Deck area of 135m² with high specification crane
- Dedicated onboard survey suite for a range of survey ops
- Bow and stern fenders for optional cargo transfer
- Central deck moon-pool for diving operations

Description and features

General specification

| | |
|------------------------|-------------------|
| Length overall: | 26.04m |
| Beam: | 10.90m |
| Max. draft: | 2.16m |
| Material: | Aluminium |
| Aft deck space: | 100m ² |
| Fwd deck space: | 35m ² |
| Maximum speed: | 22 knots |
| Fuel capacity: | 35 tonnes |
| Cargo capacity: | 40 tonnes |
| Range: | 1,300 nm |

Machinery

| | |
|------------------------|----------------------------------|
| Main engines: | 2 x MAN D2862 LE466 |
| Gearbox: | 2 x ZF-Marine, 3050 |
| Auxillary sets: | 1 x 66kVA & 1 x 41kVA generators |
| Deck crane: | P x HEILA HLM 20-35 TMC |
| Bow thrusters: | Hercules 2 x 65hp |

Classification

| | |
|------------------------|--|
| Class notation: | +100A1 SSc Catamaran, HSC, Workboat G3 |
| Flag / coding: | UK Cat 1 inc. DG |
| Personnel: | 12 pax / 6 crew |

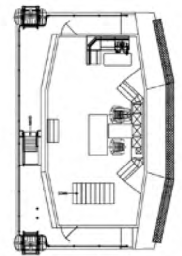
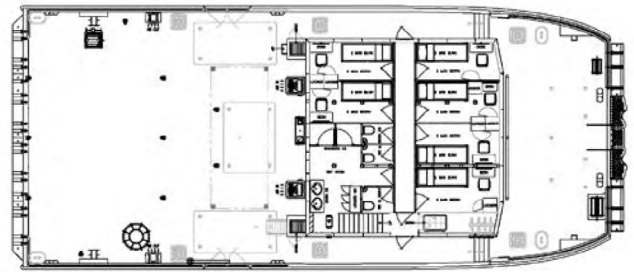
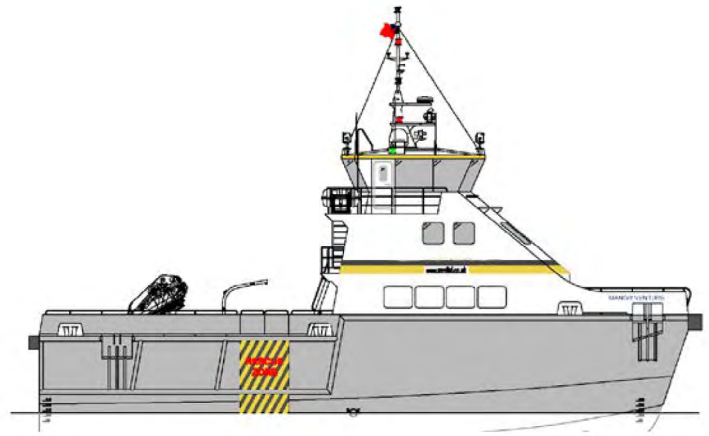

Can't find what you are looking for?

Contact our global sales team at sales@oegrenewables.com or visit our website to find your regional representative at oeg.group

E & OE – All dimensions and weights are accurate at the time of creation. Please check exact specifications of units with your local representative when ordering.

